

everX Flow™ Technique Guide

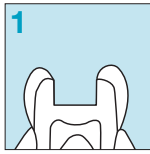

SHORT-FIBRE REINFORCED FLOWABLE COMPOSITE FOR DENTIN REPLACEMENT

Direct restorations



1 Prepare cavity.

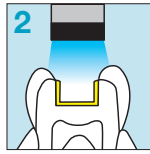

2 Bond and light-cure.

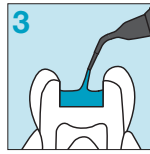

3 Place everX Flow; leave sufficient space for the overlaying composite.

Class II and large cavities

3a

3b

Build first the missing walls using a conventional light-cured restorative composite. The wall should be thick enough to withstand the application pressure of everX Flow.

Irradiation Time and Effective Depth of Cure	
Irradiation time	10 sec. (High Power LED) (>1200 mW/cm ²) 20 sec. (Halogen/ LED) (>700 mW/cm ²)
Shade	
Bulk shade	5.5 mm
Dentin shade	2.0 mm

The Bulk shade can be placed using a bulk filling technique (up to 5.5mm). The Dentin shade should be placed and light-cured in layers of 2.0mm.

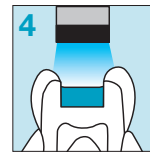

4 Light-cure.

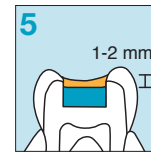

5 Cover with composite.

everX Flow™ Technique Guide



SHORT-FIBRE REINFORCED FLOWABLE COMPOSITE FOR DENTIN REPLACEMENT

Core build-up

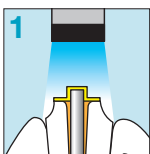

1 Prepare the surfaces to be bonded. Bond and light-cure.

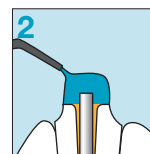

2 Use everX Flow to build the core.

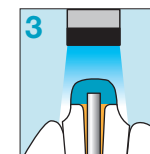

3 Light-cure.

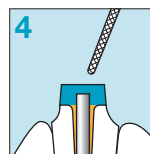

4 Contour & finish the core.

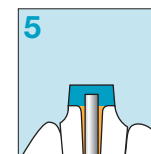

5 Final core build-up preparation.

Irradiation Time and Effective Depth of Cure	
Irradiation time	10 sec. (High Power LED) (>1200 mW/cm ²) 20 sec. (Halogen/ LED) (>700 mW/cm ²)
Shade	
Bulk shade	5.5 mm
Dentin shade	2.0 mm

The final indirect restoration should fully cover the everX Flow core build-up.

Prior to use, carefully read the instructions for use.